



Ariete LLC User Guide

Magnetic Laser Sights for "Classic" pistols

These systems use a high tech rare-earth magnet to strongly attach the mount to the steel pistol frame. Now you can install modern accessories on popular, classic, military-style pistols that do not have built-in accessory mounting rails.

The Magnetic Laser Mount is secured to the pistol by the Neodymium rare-earth magnet with the magnetic lines of force passing up through the "dust cover" surrounding the pistol spring through the sidewalls and back to the magnet.

The mount has high attraction in the vertical direction and the "Anti-Recoil Tab" keeps the mount from sliding off the front of the pistol.

The "Protective Poly-Coat" keeps the pistol from being marred when the sight is installed or removed.

When the laser is removed and reinstalled it retains its "zero" so the Laser does not need to stay on the pistol "24/7".

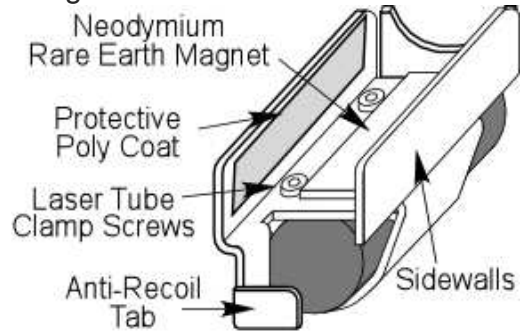

"Quick Change" Magnetic Laser Mounts for pistols with Weaver" or "Picatinney" rails

For rail-equipped pistols with alloy, or composite frames, use the "quick Change" mount. The laser module magnetically snaps onto a magnetic accessory rail adapter. It can be carried separately (or left at home) and quickly installed or removed as needed.

It retains its "zero" so the laser does not need to stay on the pistol "24/7".

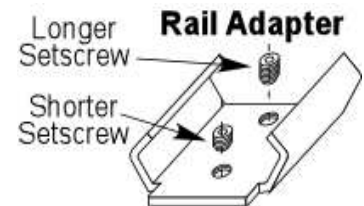

Magnetic Laser Module

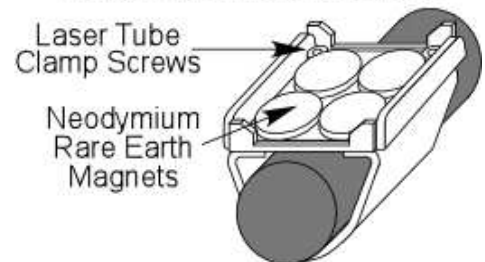

"New-Tech" Magnetic Laser Mounts

for Alloy or Composite Frame pistols without rails

This is a new concept for laser sights for aluminum alloy or polymer framed pistols without accessory rails. It uses a new, high tech, all weather, "Ultra High Bond", industrial adhesive to hold a thin magnetic adapter to the non-magnetic pistol frame. The "permanent" adhesive does not damage the pistol and can be removed if needed.

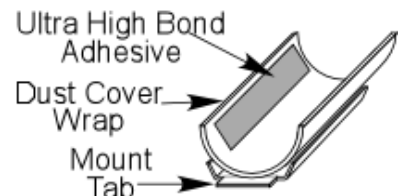

The magnetic laser module snaps onto the "NewTech" adapter is the same as the "quick Change" module described above

It retains its "zero" so the laser module does not need to stay on the pistol "24/7".



Magnetic Laser Sights General Information

Zeroing the Sight (All Models)

The four adjustment screws at the front of the laser tube cannot be guaranteed to be exactly horizontal or vertical due to thread tolerances on the switch housing at the back of the sight, however, the dot can be moved to precisely conform to the impact location using the following procedure: With the laser “on”, shine the red dot on a wall at the desired distance. (20 feet is a good starting point) Observe the sight picture on the iron sights and the red dot. If the dot is not exactly on top of the front post it can be moved to be perfectly aligned: Using the supplied hex wrench, loosen the setscrew (counterclockwise) on the side of the tube in the direction you want the dot to move about ¼ turn. Then gently tighten the setscrew on the opposite side of the laser tube. **DO NOT OVER TIGHTEN!** Shine the laser on the wall again and check the sight picture.



If it's still not correct repeat the procedure until the desired sight picture is achieved.

Ambidextrous Operation (All Models)

The Magnetic Laser Sight's on / off switch can be changed from right hand to left hand operation by loosening the four screws clamping the laser tube to the mount, rotating the laser tube, re-tightening the screws (*Do not over-tighten*); and re-zeroing the laser.

Batteries (All Models)

The Ariete Magnetic Laser Sights use 3, commonly available, button batteries which have a life of 1-2 hours on time at full brightness depending on battery type and manufacturer.

Compatible battery types:

- **GPA76, D76A, S76, GPA76, PX76A, A76**
- **G13A, V13GA, AG13, G13-A**
- **357,357A, D357, V357, GP357**
- **CA18, CA19**
- **LR44, SR44,CX44, SR44W**
- **L1154, LR1154, SR1154**
- **675A, RPX675, PX675A**
- **V13GA, RW82, 228, 1128MP, 1166A**
- **208-904, 280-62, SB-F9, SB-B9**

M1911 Magnetic Laser Sight

Compatibility:

The M1911 Magnetic Laser Sight was designed around the classic US "Government Issue" Colt Model 1911 semi -auto pistol. It has been tested on several different variations of the 1911 including the issue 1911A1, Norwegian M1914, Argentine M1923, Norinco copies, Colt Compact (commander), and various stainless steel versions.



It will not fit on alloy or polymer variations or the long frame / long slide variations.

For 1911 pistols with accessory rails and of any frame material use the Ariete LLC Universal Rail Mount

Installation:

Every M1911 Magnetic Laser Sight was factory fitted to a standard size 1911. Sometimes minor variations in the frame's "dust cover" widths occur between manufacturers. The tab at the rear of the mount is inserted into the trigger guard. The sight mount should pivot onto the gun smoothly and have no discernable spacing between the mount and the frame (movement between the sight and the slide can be mistaken for the fit on the frame) If the sight is too tight, spread the side walls slightly so that the sight snaps on smoothly. If the sight is too loose, narrow the side walls slightly. The inside of the walls are protected with poly tape coating to avoid any marring of the frame.



The sight is strongly attracted to the pistol. Watch out for pinched fingers!

Sight Removal:

The M1911 Magnetic Laser Sight has very powerful attraction in the vertical direction due to the neodymium rare-earth magnet. The best removal technique is to pry the sight off with the thumb and forefinger at the very front of the laser tube.

Replacing Batteries:

The 1911 Magnetic Laser Sight batteries can be changed with the following procedure. 1- Remove sight from pistol 2- Remove the 4 screws clamping the laser tube to the sight mount. 3- Remove the laser tube and unscrew the switch cap. Replace the button batteries with new compatible batteries with the + sign towards the back of the tube. 4- Reverse steps 1 and 2. *Do not over tighten the screws.* 5- re-zero the sight if needed.

Hi-Power Magnetic Laser Sight

Compatibility:

The Hi-Power Magnetic Laser Sight was designed around the classic FN Browning Hi Power semi -auto pistol. It has been tested on several different variations of the BHP including the issue FN, Argentine, and Inglis versions



It will not fit on alloy or polymer variations or any long frame / long slide variations.

For Hi Power clones with accessory rails and of any frame material use the Ariete LLC Universal Rail Mount

Installation:

Every Hi-Power Magnetic Laser Sight was factory fitted to a standard size BHP. Sometimes minor variations in the frame's "dust cover" widths occur between manufacturers. The recoil tab at the rear of the mount is inserted into the trigger guard. The sight mount should pivot onto the gun smoothly and have no discernable spacing between the mount and the frame (movement between the sight and the slide can be mistaken for the fit on the frame) If the sight is too tight, spread the side walls slightly so that the sight snaps on smoothly. If the sight is too loose, narrow the side walls slightly. The inside of the walls are protected with poly tape coating to avoid any marring of the frame.

The sight is strongly attracted to the pistol. Watch out for pinched fingers!

Sight Removal:

The Hi Power Magnetic Laser Sight has very powerful attraction in the vertical direction due to the neodymium rare-earth magnet. The best removal technique is to pry the sight off with the thumb and forefinger at the very front of the laser tube.

Replacing Batteries:

The Hi Power Magnetic Laser Sight batteries can be changed with the following procedure. 1- Remove sight from pistol 2- Remove the 4 screws clamping the laser tube to the sight mount. 3- Remove the laser tube and unscrew the switch cap. Replace the button batteries with new compatible batteries with the + sign towards the back of the tube. 4- Reverse steps 1 and 2. *Do not over tighten the screws.* 5- re-zero the sight if needed.

Tokarev Magnetic Laser Sight

Compatibility:

The Tokarev Magnetic Laser Sight was designed around the classic Tokarev TT30-TT33 semi -auto pistol. It has been tested on several different variations of the Tokarev including the issue Soviet, Chinese, and commercial versions



Installation:

Every Tokarev Magnetic Laser Sight was factory fitted to a standard size Tokarev. Sometimes minor variations in the frame's "dust cover" widths occur between manufacturers. The recoil tab at the rear of the mount is inserted into the trigger guard. The sight mount should pivot onto the gun smoothly and have no discernable spacing between the mount and the frame (movement between the sight and the slide can be mistaken for the fit on the frame) If the sight is too tight, spread the side walls slightly so that the sight snaps on smoothly. If the sight is too loose, narrow the side walls slightly. The inside of the walls are protected with poly tape coating to avoid any marring of the frame.

The sight is strongly attracted to the pistol. Watch out for pinched fingers!

Sight Removal:

The Tokarev Magnetic Laser Sight has very powerful attraction in the vertical direction due to the neodymium rare-earth magnet. The best removal technique is to pry the sight off with the thumb and forefinger at the very front of the laser tube.

Replacing Batteries:

The Tokarev Magnetic Laser Sight batteries can be changed with the following procedure. 1- Remove sight from pistol 2- Remove the 4 screws clamping the laser tube to the sight mount. 3- Remove the laser tube and unscrew the switch cap. Replace the button batteries with new compatible batteries with the + sign towards the back of the tube. 4- Reverse steps 1 and 2. *Do not over tighten the screws.* 5- re-zero the sight if needed.

CZ-75 Magnetic Laser Sight

Compatibility:

The CZ-75 Magnetic Laser Sight was designed around the classic CZ-75 and CZ-75B semi -auto pistols. It has been tested on several different variations of the CZ-75



It will not fit on alloy or polymer variations.

For CZ clones with accessory rails and of any frame material use the Ariete LLC Universal Rail Mount

Installation:

Every CZ-75 Magnetic Laser Sight was factory fitted to a standard size CZ-75. Sometimes minor variations in the frame's "dust cover" widths occur between manufacturers. The recoil tab at the rear of the mount is inserted into the trigger guard. The sight mount should pivot onto the gun smoothly and have no discernable spacing between the mount and the frame (movement between the sight and the slide can be mistaken for the fit on the frame) If the sight is too tight, spread the side walls slightly so that the sight snaps on smoothly. If the sight is too loose, narrow the side walls slightly. The inside of the walls are protected with poly tape coating to avoid any marring of the frame.

The sight is strongly attracted to the pistol. Watch out for pinched fingers!

Sight Removal:

The CZ-75 Magnetic Laser Sight has very powerful attraction in the vertical direction due to the neodymium rare-earth magnet. The best removal technique is to pry the sight off with the thumb and forefinger at the very front of the laser tube.

Replacing Batteries:

The CZ-75 Magnetic Laser Sight batteries can be changed with the following procedure. 1- Remove sight from pistol 2- Remove the 4 screws clamping the laser tube to the sight mount. 3- Remove the laser tube and unscrew the switch cap. Replace the button batteries with new compatible batteries with the + sign towards the back of the tube. 4- Reverse steps 1 and 2. *Do not over tighten the screws.* 5- re-zero the sight if needed.

Universal Rail Mount Magnetic Laser Sight

Compatibility:

The Rail Mount Magnetic Laser Sight was designed around the standard “Weaver” and “Picatinny” accessory rail dimensions.



It will work properly on steel, alloy, or polymer accessory rails.

Installation:

The Rail Mount Magnetic Laser Sight is a two unit device. The magnetic adapter is fitted to the accessory rail and the Laser Mount is then snapped onto the adapter and held in place by magnetic force. 1- Fit the adapter to the rail by backing out the short and long adapter setscrews and sliding the adapter onto the front of the rail until a recoil cross groove can be aligned with a hole in the adapter. Note that the holes are differently positioned on the adapter to allow flexibility in mounting by rotating the adapter. 2- Use the longer setscrew to secure the adapter to the groove. 3- The shorter setscrew can then be placed into the other hole to take up any looseness. (*Do not over-tighten the setscrews*)



4- The mount can then be snapped on to the magnetic adapter. If the on / off switch is not close to the trigger guard, loosen the four screws clamping the laser tube to the mount, slide the laser tube to the desired position, re-tighten the screws (*Do not over-tighten*); and re-zero the laser.

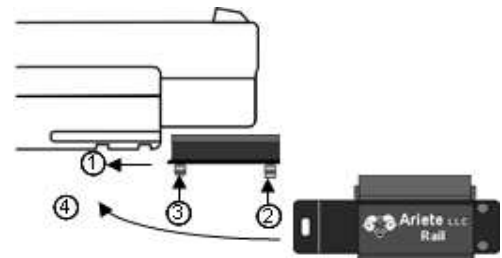

The mount is strongly attracted to the adapter. Watch out for pinched fingers!

Mount Removal:

The Rail Mount Magnetic Laser Sight has very powerful attraction in the vertical direction due to the neodymium rare-earth magnet. The best removal technique is to pry the sight off with the thumb and forefinger at the rear of the laser tube.

Replacing Batteries:

The Rail Mount Magnetic Laser Sight batteries can be changed with the following procedure. 1- Remove sight from pistol. 2- Unscrew the switch cap. 3- Replace the button batteries with new compatible batteries with the + sign towards the back of the tube. 4- Reverse step 2. 5- re-zero the sight if needed.

Beretta 92 Magnetic Laser Sight

Compatibility:

The Beretta 92 Magnetic Laser Sight was designed specifically for the Beretta 92 and its clones and variations.



It will work properly on steel, alloy, or polymer frames.

For Beretta clones with accessory rails and of any frame material use the Ariete LLC Universal Rail Mount

Installation:

The Beretta 92 Magnetic Laser Sight is a two unit device. The magnetic adapter is fitted to the frame of the pistol and the Laser Mount is then snapped onto the adapter and held in place by magnetic force.

WARNING: Once installed, the adapter may not be moved or removed without damage to the adapter!

- 1- Clean the frame with solvent and pencil a line $\frac{1}{2}$ " (12mm) from the front of the frame.
- 2- Peel the protective covers from the adapter adhesive patches and place the adapter on the pistol
- 3- Clamp securely for 12 hours using a clamp or remove the slide and use the supplied wire ties
- 4- Snap the Magnetic Mount onto the adapter by tilting the sight and engaging the front tab first.
- 5- zero the laser.

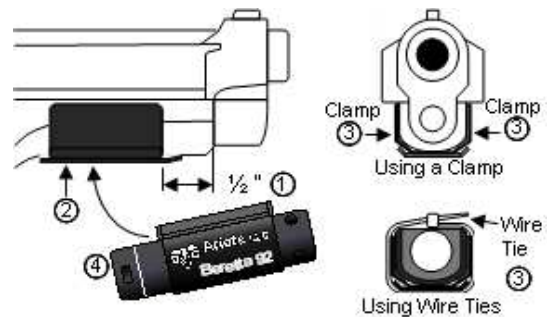

The mount is strongly attracted to the adapter. Watch out for pinched fingers!

Mount Removal:

The Beretta 92 Magnetic Laser Sight has very powerful attraction in the vertical direction due to the neodymium rare-earth magnet. The best removal technique is to pry the sight off with the thumb and forefinger at the rear of the laser tube.

Replacing Batteries:

The Beretta 92 Magnetic Laser Sight batteries can be changed with the following procedure. 1- Remove sight from pistol. 2- Unscrew the switch cap. 3- Replace the button batteries with new compatible batteries with the + sign towards the back of the tube. 4- Reverse step 2. 5- re-zero the sight if needed.

SIG 226 Magnetic Laser Sight

Compatibility:

The SIG 226 Magnetic Laser Sight was designed specifically for the SIG 226 and its clones and variations. It will work properly on steel, alloy, or polymer frames.



For SIG 226 clones with accessory rails and of any frame material use the Ariete LLC Universal Rail Mount

Installation:

The SIG 226 Magnetic Laser Sight is a two unit device. The magnetic adapter is fitted to the frame of the pistol and the Laser Mount is then snapped onto the adapter and held in place by magnetic force.

WARNING: Once installed, the adapter may not be moved or removed without damage to the adapter!

- 1- Clean the frame with solvent and pencil a line 1/4" (6.4mm) from the front of the frame.
- 2- Peel the protective covers from the adapter adhesive patches and place the adapter on the pistol
- 3- Clamp securely for 12 hours using a clamp or remove the slide and use the supplied wire ties
- 4- Snap the Magnetic Mount onto the adapter by tilting the sight and engaging the front tab first.
- 5- zero the laser.

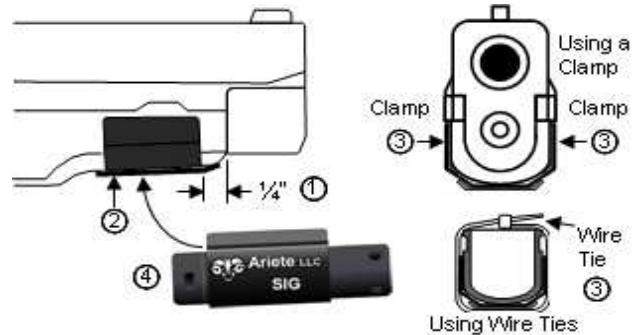

The mount is strongly attracted to the adapter. Watch out for pinched fingers!

Mount Removal:

The SIG 226 Magnetic Laser Sight has very powerful attraction in the vertical direction due to the neodymium rare-earth magnet. The best removal technique is to pry the sight off with the thumb and forefinger at the rear of the laser tube.

Replacing Batteries:

The SIG 226 Magnetic Laser Sight batteries can be changed with the following procedure. 1- Remove sight from pistol. 2- Unscrew the switch cap. 3- Replace the button batteries with new compatible batteries with the + sign towards the back of the tube. 4- Reverse step 2. 5- re-zero the sight if needed.

Glock (Gen 1&2) Magnetic Laser Sight

Compatibility:

The Glock Magnetic Laser Sight was designed specifically for the Glock and its clones and variations. It will work properly on steel, alloy, or polymer frames.



For Glock clones with accessory rails and of any frame material use the Ariete LLC Universal Rail Mount

Installation:

The Glock Magnetic Laser Sight is a two unit device. The magnetic adapter is fitted to the frame of the pistol and the Laser Mount is then snapped onto the adapter and held in place by magnetic force.

WARNING: Once installed, the adapter may not be moved or removed without damage to the adapter!

1- Clean the frame with solvent and pencil a line 3/4" (19mm) from the front of the frame.

2- Peel the protective covers from the adapter adhesive patches and place the adapter on the pistol

3- Clamp securely for 12 hours using a clamp or remove the slide and use the supplied wire ties

4- Snap the Magnetic Mount onto the adapter by tilting the sight and engaging the front tab first.

5- zero the laser.

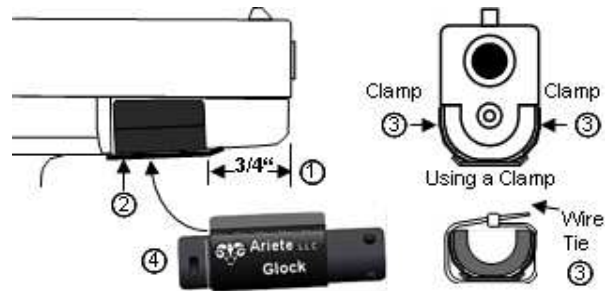

The mount is strongly attracted to the adapter. Watch out for pinched fingers!

Mount Removal:

The Glock Magnetic Laser Sight has very powerful attraction in the vertical direction due to the neodymium rare-earth magnet. The best removal technique is to pry the sight off with the thumb and forefinger at the rear of the laser tube.

Replacing Batteries:

The Glock Magnetic Laser Sight batteries can be changed with the following procedure. 1- Remove sight from pistol. 2- Unscrew the switch cap. 3- Replace the button batteries with new compatible batteries with the + sign towards the back of the tube. 4- Reverse step 2. 5- re-zero the sight if needed.